

PARKING SHED

# ESTIMATE

**NAME OF WORK:- PROPOSED CONSTRUCTION OF  
PARKING SHED ( For Agri. Vehicles and  
equipments) AT GAT NO. 354/ Part OF VILL.  
KARADKHEL , TQ. UDGIR, DIST. LATUR. FOR :  
FARM RICH PRODUCER COMPANY LTD., LATUR.**

ESTIMATED COST :-

Rs.	9.40	LAKHS	EXCL GST
Rs,	10.50	LAKHS	INCL GST

Prepared By:

**AVG CONSULTANTS** (ESTB.1988)

**Ar. Shruti Anant Gade**

B. Arch. , M.Arch.  
(Sustainable Architecture)

**Er. Anant Gade**

D.C.E., B.E.Civil, B.A., B.G.L., LL.B.,  
PG.D. Valuation., PG.D. H.R.D., PGD.  
Envir.Sci, PG. G.D.C.&A., PG.D. I.S.&S.M.,  
M.A.Socio., LL.M., PG.D.Guidance &  
Couns., (M.B.A.)

Registration No. CA/2017/90228

Reg. No. NJC.C.I.T./1-16/59/2006-07

Civil Engineer, Architects, Environmental and Green Building Consultants and Govt. Regd. Valuers

"Trupti", Behind AXIS Bank, Ganesh Nagar, Ausa Road, Latur. 413 512.

Ph.: 02382- 95907, Mobile : +91-9890029196

E-mail: anantgade@gmail.com



BY:

**NAME OF WORK:- PROPOSED CONSTRUCTION OF PARKING SHED ( For Agri. Vehicles and equipments) AT GAT NO. 354/ Part OF VILL. KARADKHEL , TQ. UDGIR, DIST. LATUR. FOR : FARM RICH PRODUCER COMPANY LTD., LATUR.**

## **FACE SHEET**

*The Work Construction of Paking Shed for Agricultural Vehicles and equipments at Karadkhel, Tq. Udgir, Dist. Latur has been Proposed by M/s. Farm Rich Producer Co. Ltd.*

*Accordingly detailed estimate has been prepared and submitted alongwith detailed Plan which is as per the norms prescribed by the Maharashtra State Warehousing Corporation. Provisions made in the estimate are as per the specifications.*

### **Main GODOWN**

- 1) Excavation For Foundation In Soft, Hard Murum & Boulders
- 2) PCC 1:3:6 For Foundation & Bedding
- 3) B.B.Masonry In CM 1:6 in Foundation.
- 4) Rolling Shutter for Door Openings.
- 5) M30 C.C. tremix flooring of 200 mm thickness.
- 6) PEB Structural Steel Frame for Roofing with Zinalum Corrugated Sheets for roofing.

*All necessary provisions are made in the estimate.*

*The estimate is based on current SSR 2021-22. Rate analysis for all items are included with the estimate with all above provisions.*

Submitted for further action regarding the project.

  
Engineer/ Architect

### **Er. Anant V. Gade**

D.C.E., B.E. CIVIL, B.A., B.G.L., LL.B.,  
PG.D.H.R.D., PG.D. Envir.Sci., PG.D.Val.,  
PG. D.I.S.&S.M., PG.G.D.C.&A., M.A. Socio.  
LL.M., PG.D.Guid.& Conus., (M.B.A.)  
Architectural Consultant and  
Govt.Regd.Valuer



**NAME OF WORK:- PROPOSED CONSTRUCTION OF PARKING SHED ( For Agri. Vehicles and equipments) AT GAT NO. 354/ Part OF VILL. KARADKHEL , TQ. UDGIR, DIST. LATUR. FOR : FARM RICH PRODUCER COMPANY LTD., LATUR.**

### **GENERAL ABSTRACT**

<b>(A) COST OF WORK PORTION</b>	<b>Rs.</b>	<b>914583.00</b>
<b>(B) COST OF ROYALTY &amp; Q.C.TESTING CHARGES</b>	<b>Rs.</b>	<b>25205.00</b>
<b>TOTAL</b>	<b>Rs.</b>	<b>939788.00</b>
1) ADD 12% FOR GOODS AND SERVICES TAX	<b>Rs.</b>	<b>109750.00</b>
<b>GRAND TOTAL</b>	<b>Rs.</b>	<b>1049538.00</b>
SAY	<b>Rs.</b>	<b>1050000.00</b>



**Engineer/ Architect**

**Er. Anant V. Gade**

D.C.E., B.E. Civil, B.A., B.G.L., LL.B.,  
PG.D.H.R.D., PG.D. Envir.Sci., PG.D.Val.,  
PG. D.I.S.&S.M., PG.G.D.C.&A., M.A. Socio.  
LL.M., PG.D.Guid.& Conus., (M.B.A.)  
Architectural Consultant and  
Govt.Regd.Valuer

**NAME OF WORK:- PROPOSED CONSTRUCTION OF PARKING SHED ( For Agri. Vehicles and equipments) AT GAT NO. 354/ Part OF VILL. KARADKHEL , TQ. UDGIR, DIST. LATUR. FOR : FARM RICH PRODUCER COMPANY LTD., LATUR.**

**ABSTRACT**

SR. NO.	DESCRIPTION OF ITEM	QUANTITY	RATE	UNIT	TOTAL AMOUNT
1	Excavation for <b>foundation in earth, soil of all types, sand, gravel and soft murum</b> , including removing the excavated material up to a distance of 50 m. beyond the building area & stacking and spreading as directed, dewatering, preparing the bed for the foundation and necessary back filling, ramming, watering including shoring and strutting etc. complete. <b>(Lift upto 1.5 m.) By Mechanical</b> Bd.A.1 Page No. 259 <b>SSR OF 2021-22 ITEM NO. 21.02 &amp; PAGE NO.197</b> <b>BASIC RATE</b>	5.292	193.00	Cu.M.	1021.00
2	Excavation for <b>foundation in hard murum</b> including removing the excavated material upto distance of 50 metres beyond the building area and stacking and spreading as directed, dewatering, preparing the bed for the foundation and necessary back filling, ramming, watering including shoring and strutting etc. complete. <b>(Lift upto 1.50 m) By</b> Bd.A.2 Page No. 259 <b>SSR OF 2021-22 ITEM NO. 21.06 &amp; PAGE NO.197</b> <b>BASIC RATE</b>	4.788	212.00	Cu.M.	1015.00
3	Excavation for <b>foundation in Hard murum and boulders</b> including removing the excavated material upto a distance of 50 metres, beyond the building area and stacking and spreading as directed, dewatering, preparing the bed for the foundation and necessary back filling, ramming, watering including shoring and strutting etc. complete. <b>(Lift from 1.5 m to 3.0 m.) By</b> Bd.A.3 Page No. 259 <b>SSR OF 2021-22 ITEM NO. 21.12 &amp; PAGE NO.198</b> <b>BASIC RATE</b>	5.292	291.00	Cu.M.	1540.00
4	Providing and laying Cast in <b>situ/Ready Mix cement concrete in M-10</b> of trap/ granite/ quartzite/ gneiss metal <b>for foundation and bedding</b> including bailing out water, formwork, laying/pumping, compacting, roughening them if special finish is to be provided, finishing if required and curing complete, <b>with fully automatic micro processor based PLC with SCADA</b> enabled reversible Drum Type mixer/concrete Batch mix plant (Pan mixer) etc. complete. <b>With fine aggregate (Natural Sand / Crushed sand VST</b> Bd. E. 1 Page No. 287 <b>SSR OF 2021-22 ITEM NO. 24.01 &amp; PAGE NO.226</b> <b>RATE ANALYSIS</b>	11.034	5842.03	Cu.M.	64461.00

## ABSTRACT

SR. NO.	DESCRIPTION OF ITEM	QUANTITY	RATE	UNIT	TOTAL AMOUNT
5	<p>Providing and laying in situ/Ready Mix cement concrete M-20 of trap / granite /quartzite/ gneiss metal for <b>R.C.C. work in foundations like raft, strip foundations, grillage and footings</b> of R.C.C. columns and steel stanchions etc. including bailing out water, formwork, laying/pumping cover blocks, compaction and curing roughening the surface if special finish is to be provided (Excluding reinforcement and structural steel) etc. complete, <b>with fully automatic micro processor based PLC with SCADA</b> enabled reversible Drum Type mixer/ concrete Batch mix plant (Pan mixer) etc. <del>complete with fine aggregate (Natural Sand)</del> Bd.F.3 Page No. 298 and B.7, Page No.38</p> <p><b>SSR OF 2021-22 ITEM NO. 25.11 &amp; PAGE NO.230</b> <b>RATE ANALYSIS</b></p>	2.520	6755.26	Cu.M.	17023.00
6	<p>Providing and laying <b>Cast in situ/Ready Mix cement concrete M-20</b> of trap / granite /quartzite/ gneiss metal for <b>R.C.C. beams and lintels</b> as per detailed designs and drawings or as directed including steel centering, formwork, cover blocks, laying/pumping, compaction and roughening the surface if special finish is to be provided and curing etc. complete. (Excluding reinforcement and structural steel). with fully automatic micro processor based PLC with SCADA enabled reversible Drum Type mixer/ concrete Batch mix plant (Pan mixer) etc. <del>complete with fine aggregate (Natural Sand)</del> Bd.F.6 Page No. 300 and B.7, Page No.38</p> <p><b>SSR OF 2021-22 ITEM NO. 25.5 &amp; PAGE NO.234</b> <b>RATE ANALYSIS</b></p>	1.932	11090.56	Cu.M.	21427.00
7	<p>Providing <b>second class Burnt Brick masonry</b> with conventional/ I.S. type bricks in <b>cement mortar 1:6 in foundations and plinth of inner walls/ in plinth external walls</b> including bailing out water manually , striking joints on unexposed faces, raking out joints on exposed faces and Bd.G. 1 Page No. 313</p> <p><b>SSR OF 2021-22 ITEM NO. 27.01 &amp; PAGE NO.254</b> <b>RATE ANALYSIS</b></p>	4.830	8067.26	Cu.M.	38965.00
8	<p>Filling in <b>plinth and floors with contractors material/brought from outside</b> and approved by Engineer incharge in layers of 15cm. to 20cm. including watering and compaction etc. complete.</p> <p>Bd.A.11 Page No. 263</p> <p><b>SSR OF 2021-22 ITEM NO. 21.37 &amp; PAGE NO.201</b> <b>RATE ANALYSIS</b></p>	32.400	728.55	Cu.M.	23605.00
9	<p>Providing <b>soling using 80 mm size trap metal in 15 cm. layer</b> including filling voids with Crushed sand/grit ramming watering etc. complete As directed by Engineer in charge.</p> <p><b>SSR OF 2021-22 ITEM NO. 21.4 &amp; PAGE NO.201</b></p>				

## ABSTRACT

SR. NO.	DESCRIPTION OF ITEM	QUANTITY	RATE	UNIT	TOTAL AMOUNT
	<b>RATE ANALYSIS</b>	21.600	1735.65	Cu.M.	37490.00
10	<p>Providing and fabricating structural steel work in rolled sections like joists, channels, angles, tees etc. as per detailed design and drawings or as directed including cutting, fabricating, hoisting, erecting, fixing in position making riveted / bolted /welded connections without connecting plates, braces etc. and including one coat of anticorrosive paint and over it two coats of oil painting of Bd.C.2 Page No. 275</p> <p><b>SSR OF 2021-22 ITEM NO. 23.01 &amp; PAGE NO.223</b></p> <p><b>BASIC RATE</b></p>	1.873	89181.00	M.T.	167036.00
11	<p>Providing and fixing rolling shutter fabricated from steel laths of minimum thickness 0.9 mm with lock plate of 3.15 mm thickness reinforced with 35 x 35 x 5 mm angle section fitted with sliding bolts and handles for both sides, deep M.S. channel section of depth and thickness not less than 65 mm and 3.15 mm respectively with hold fast arrangements, M.S. Bracket plate 300 x 300 x 3.15 mm minimum size and shape with square bar, suspension shaft of minimum 32 mm diameter, hood cover of M.S. sheet not less than 0.9 mm thickness and of any size at top and safety devices including mechanical gear operation arrangement consisting of worm gear wheels and worms of high grade cast iron or mild steel and one coat of red lead primer etc. complete. (I.S. 6248-1979) Bd.T.55, Page No. 510</p> <p><b>SSR OF 2021-22 ITEM NO. 39.24 &amp; PAGE NO.318</b></p> <p><b>BASIC RATE</b></p>	30.000	4310.00	Sq.M.	129300.00
12	<p>Providing and fixing colour coated Zinalume ( R ) AZ150 ( min 150 gms/sq.mt. total on each side ) profiled sheets for roofing. The feed material is manufactured out of nominal 0.45 mm Base Metal Thickness ( BMT ) (0.5 mm TCT ), Hi-strength steel with min.550 MPa yield strength, metallic hot dip coated with Aluminium-Zinc alloy (55% aluminium 43.4% zinc 1.6% silicon) with COLORBOND ( R ) steel quality super durable polyester paint coat ( with inorganic pigment). The paint shall have a total coating thickness of nominal 35 um, comprising of nominal 25 um exterior coat on top surface and nominal 10 um reverse coat on back surface. Profile sheet shall have nom. 950-1050 mm effective cover width and nominal 25-30 mm deep ribs with subtle square fluting in the five pan at nominal 180-250 mm center-to-center. The end rib shall be designed for anti-capillary groove. and return leg. The feed material should have roll manufacturers product As directed by Engineer In charge.</p> <p><b>SSR OF 2021-22 ITEM NO. 38.34 &amp; PAGE NO.302</b></p> <p><b>BASIC RATE</b></p>	223.240	1095.00	Sq.M.	244448.00

## ABSTRACT

SR. NO.	DESCRIPTION OF ITEM	QUANTITY	RATE	UNIT	TOTAL AMOUNT
13	Providing and laying in situ cement concrete M30 with tremix treatment for 200 mm thickness for flooring with groove cutting of 4mm wide and 20mm deep with necessary refilling with bitumen As directed by Engineer in charge <b>SSR OF 2021-22 ITEM NO. 33.31 &amp; PAGE NO.277</b> <b>RATE ANALYSIS</b>	108.000	1548.63	Sq.M.	167252.00
<b>TOTAL(A) Rs.</b>					<b>914583.00</b>
14	<b>ROYALTY CHARGES</b> :- Supply of Rubble, Murum, Soil, 60mm./40mm. metal (Hand broken), royalty charges are not included in the rates.[As per Govt. of Maharashtra, Revenue and Forest Departments Gazette No.67 Dt.15 May,2015. States that the royalty charges of Rs.141.34/Cu.M. ) are considered. The surcharge levied on Royalty shall also be payable to the <b>E DSR ITEM NO. ... &amp; PAGE NO....</b> FOR SAND FOR OTHER METAL	19.100 54.000	158.30 141.34	Cu.M. Cu.M.	3023.00 7632.00
<b>Total Royalty Charges</b>					<b>10655.00</b>
15	<b>Laboratory testing charges</b> are not considered in the Rate Abstracts. Where ever required separate item shall be taken in the estimate for material testing charges, on the basis of testing frequency and charges fixed by Vigilance & Quality Control Circle, for the current year and shall form part of tender. testing of material by Quality control and <b>certified quality must be use by contractor.</b> <b>BASIC TEST OF AGGREGATE</b> Water Absorption, Specific Gravity, Impact Value, Crushing Value <b>BASIC TEST OF CEMENT</b> Standard Consistency Fineness, Specific Gravity, Setting Time ( Initial & Final), Compressive Strength, Soundness <b>BRICKS</b> Water Absorption , Compressive Strength, Efflorescence (Set of 5 bricks) <b>CONCRETE</b> Compressive strength of C.C.Cube (Set of 3 cubes) <b>MURUM-HARD</b> Sieve Analysis <b>STEEL BAR TESTING</b> Upto 16 mm (Set of 3 Bars)	1.000 1.000 1.000 9.000 1.000 0.000	2450.00 3550.00 2050.00 650.00 650.00 1200.00	Nos. Nos. Nos. Nos. Nos. Nos.	2450.00 3550.00 2050.00 5850.00 650.00 0.00
<b>Total Testing Charges</b>					<b>14550.00</b>
<b>TOTAL(B) Rs.</b>					<b>25205.00</b>
<b>TOTAL(A+B) Rs.</b>					<b>940000.00</b>
Add for GST					914583.000 X12% 109749.96
<b>GRAND TOTAL Rs.</b>					<b>1050000.00</b>



*(Handwritten Signature)*

**Er. Anant V. Gade**

D.C.E., B.E. Civil, B.A., B.G.L., LL.B.,  
 PG.D.H.R.D., PG.D. Envir.Sci., PG.D.Val.,  
 PG. D.I.S.&S.M., PG.G.D.C.&A., M.A.Socio.  
 LL.M., PG.D.Guid.& Conus., (M.B.A.)  
 Architectural Consultant and  
 Govt.Regd.Valuer

NAME OF WORK:- PROPOSED CONSTRUCTION OF PARKING SHED ( For Agri. Vehicles and equipments) AT GAT NO. 354/ Part OF VILL. KARADKHEL , TQ. UDGIR, DIST. LATUR. FOR : FARM RICH PRODUCER COMPANY LTD., LATUR.

### MEASUREMENT SHEET.

SR. NO.	DESCRIPTION OF ITEM	NO.	L	B	D	QUANTITY
1	Excavation for foundation in earth, soil of all types, sand, gravel and soft murum, including removing the excavated material up to a distance of 50 m. beyond the building area & stacking and spreading as directed, dewatering, preparing the bed for the foundation and necessary back filling, ramming, watering including shoring and strutting etc. complete. (Lift upto 1.5 m) By Mechanical <b>SSR OF 2021-22 ITEM NO. 21.02 &amp; PAGE NO.197</b> FOR FOUNDATION For COLUMN (POSTS) FOUNDATION	1	14	0.60	0.60	0.300 = 1.512
	for side walls	1	1	42.00	0.45	0.200 = 3.780
		<b>TOTAL QUANTITY</b>				<b>5.292</b>
						Cu.M.
2	Excavation for foundation in hard murum including removing the excavated material upto distance of 50 metres beyond the building area and stacking and spreading as directed, dewatering, preparing the bed for the foundation and necessary back filling, ramming, watering including shoring and strutting etc. complete. (Lift upto 1.50 m) By Mechanical <b>SSR OF 2021-22 ITEM NO. 21.06 &amp; PAGE NO.197</b> FOR FOUNDATION For COLUMN (POSTS) FOUNDATION	1	14	0.60	0.60	0.200 = 1.008
	for side walls	1	1	42.00	0.45	0.200 = 3.780
		<b>TOTAL QUANTITY</b>				<b>4.788</b>
						Cu.M.
3	Excavation for foundation in Hard murum and boulders including removing the excavated material upto a distance of 50 metres, beyond the building area and stacking and spreading as directed, dewatering, preparing the bed for the foundation and necessary back filling, ramming, watering including shoring and strutting etc. complete. (Lift from 1.5 m to 3.0 m.) By Mechanical Means <b>SSR OF 2021-22 ITEM NO. 21.12 &amp; PAGE NO.198</b> FOR FOUNDATION For COLUMN (POSTS) FOUNDATION	1	14	0.60	0.60	0.300 = 1.512
	for side walls	1	1	42.00	0.45	0.200 = 3.780
		<b>TOTAL QUANTITY</b>				<b>5.292</b>
						Cu.M.

## MEASUREMENT SHEET.

SR. NO.	DESCRIPTION OF ITEM	NO.	L	B	D	QUANTITY
4	Providing and laying Cast in situ/Ready Mix cement concrete in M-10 of trap/ granite/ quartzite/ gneiss metal for foundation and bedding including bailing out water, formwork, laying/pumping, compacting, roughening them if special finish is to be provided, finishing if required and curing complete, with fully automatic micro processor based PLC with SCADA enabled reversible Drum Type mixer/concrete Batch mix plant (Pan mixer) etc. complete. With fine aggregate (Natural Sand / Crushed sand VSI Grade finely washed etc) <b>SSR OF 2021-22 ITEM NO. 24.01 &amp; PAGE NO.226</b> FOR FOUNDATION For COLUMN (POSTS) FOUNDATION					
		1	14	0.60	0.60	0.100 = 0.504
	for side walls	1	1	42.00	0.45	0.100 = 1.890
	FOR BEDDING BELOW TRIMIX FLOORING	1	1	9.00	12.00	0.080 = 8.640
		<b>TOTAL QUANTITY</b>				<b>11.034</b>
						Cu.M.
5	Providing and laying in situ/Ready Mix cement concrete M-20 of trap / granite /quartzite/ gneiss metal for R.C.C. work in foundations like raft, strip foundations, grillage and footings of R.C.C. columns and steel stanchions etc. Including bailing out water, formwork, laying/pumping cover blocks, compaction and curing roughening the surface if special finish is to be provided (Excluding reinforcement and structural steel) etc. complete, with fully automatic micro processor based PLC with SCADA enabled reversible Drum Type mixer/ concrete Batch mix plant (Pan mixer) etc. complete. With fine aggregate (Natural Sand / Crushed sand VSI Grade finely washed etc) <b>SSR OF 2021-22 ITEM NO. 25.11 &amp; PAGE NO.230</b> For COLUMN (POSTS) FOUNDATION					
		1	14	0.60	0.60	0.500 = 2.520
		<b>TOTAL QUANTITY</b>				<b>2.520</b>
						Cu.M.
6	Providing and laying Cast in situ/Ready Mix cement concrete M-20 of trap / granite /quartzite/ gneiss metal for R.C.C. beams and lintels as per detailed designs and drawings or as directed including steel centering, formwork, cover blocks, laying/pumping, compaction and roughening the surface if special finish is to be provided and curing etc. complete. (Excluding reinforcement and structural steel). with fully automatic micro processor based PLC with SCADA enabled reversible Drum Type mixer/ concrete Batch mix plant (Pan mixer) etc. complete. With fine aggregate (Natural Sand / Crushed sand VSI Grade finely washed etc) <b>SSR OF 2021-22 ITEM NO. 25.5 &amp; PAGE NO.234</b> PLINTH lintel at brickwork LEVEL					
		1	1	42.00	0.23	0.200 = 1.932
		<b>TOTAL QUANTITY</b>				<b>1.932</b>

# MEASUREMENT SHEET.

SR. NO.	DESCRIPTION OF ITEM	NO.	L	B	D	QUANTITY
---------	---------------------	-----	---	---	---	----------

Cu.M.

- 7 Providing **second class Burnt Brick masonry** with conventional/ I.S. type bricks in **cement mortar 1:6 in foundations and plinth of inner walls/ in plinth external walls** including bailing out water manually, striking joints on unexposed faces, raking out joints on exposed faces and watering etc.  
**SSR OF 2021-22 ITEM NO. 27.01 & PAGE NO.254**  
 IN PLINTH-- four side walls

$$1 \times 1 \times 42.00 \times 0.23 \times 0.500 = 4.830$$

**TOTAL QUANTITY** 4.830

Cu.M.

- 8 Filling in **plinth and floors with contractors material/brought from outside** and approved by Engineer incharge in layers of 15cm. to 20cm. including watering and compaction etc. complete.  
**SSR OF 2021-22 ITEM NO. 21.37 & PAGE NO.201**  
 FOR SHED PLINTH FILLING

$$1 \times 1 \times 12.00 \times 9.00 \times 0.300 = 32.400$$

**TOTAL QUANTITY** 32.400

Cu.M.

- 9 Providing **soling using 80 mm size trap metal in 15 cm. layer** including filling voids with Crushed sand/grit ramming watering etc. complete.  
**SSR OF 2021-22 ITEM NO. 21.4 & PAGE NO.201**  
 FOR BELOW FLOORING

$$1 \times 1 \times 12.00 \times 9.00 \times 0.200 = 21.600$$

**TOTAL QUANTITY** 21.600

Cu.M.

- 10 Providing and **fabricating structural steel work in rolled sections like joists, channels, angles, tees** etc. as per detailed design and drawings or as directed including cutting, fabricating, hoisting, erecting, fixing in position making riveted / bolted /welded connections without connecting plates, braces etc. and including one coat of anticorrosive paint and over it two coats of oil painting of approved quality and shade etc. complete.

**SSR OF 2021-22 ITEM NO. 23.01 & PAGE NO.223**

**FOR TRUSSES (0.11 Kn per Sqmtr.)**  
**For Purlins (0.06 Kn Per sqmtr.)**

$$1 \times 1 \times 108.00 \times 0.110 \times 0.102 = 1.212$$

$$1 \times 1 \times 108.00 \times 0.060 \times 0.102 = 0.661$$

**TOTAL QUANTITY** 1.873

M.T.

- 11 Providing and fixing **rolling shutter fabricated from steel laths of minimum thickness 0.9 mm with lock plate of 3.15 mm thickness** reinforced with 35 x 35 x 5 mm angle section fitted with sliding bolts and handles for both sides, deep M.S. channel section of depth and thickness not less than 65 mm and 3.15 mm respectively with hold fast arrangements, M.S. Bracket plate 300 x 300 x 3.15 mm minimum size and shape with square bar, suspension shaft of minimum 32 mm diameter, hood cover of M.S. sheet not less than 0.9 mm thickness and of any size at top and safety devices including mechanical gear operation arrangement consisting of worm gear wheels and worms of high grade cast iron or mild.  
**SSR OF 2021-22 ITEM NO. 39.24 & PAGE NO.318**

## MEASUREMENT SHEET.

SR. NO.	DESCRIPTION OF ITEM	NO.	L	B	D	QUANTITY
	FOR GODOWN	1	3	4.00	2.50	= 30.000
<b>TOTAL QUANTITY</b>						<b>30.000</b>

Sq.M.

- 12 Providing and fixing colour coated Zincolume ( R ) AZ150 ( min 150 gms/sq.mt. total on each side ) profiled sheets for roofing. The feed material is manufactured out of nominal 0.45 mm Base Metal Thickness ( BMT ) ( 0.5 mm TCT ), HI-strength steel with min.550 MPa yield strength, metallic hot dip coated with Aluminium-Zinc alloy ( 55% aluminium 43.4% zinc 1.6% silicon ) with COLORBOND ( R ) steel quality super durable polyester paint coat ( with inorganic pigment ). The paint shall have a total coating thickness of nominal 35 um, comprising of nominal 25 um exterior coat on top surface and nominal 10 um reverse coat on back surface. Profile sheet shall have nom. 950-1050 mm effective cover width and nominal 25-30 mm deep ribs with subtle square fluting in the five pan at nominal 180-250 mm center-to-center. The end rib shall be designed for anti-capillary groove. and return leg. The feed material should have coil manufacturers product

**SSR OF 2021-22 ITEM NO. 38.34 & PAGE NO.302**

FOR GODOWN ROOF

1 X 1 X 9.40 X 12.10	= 113.740
1 X 1 X 30.00 X 3.65	= 109.500

**TOTAL QUANTITY 223.240**

Sq.M.

- 13 Providing and laying in situ cement concrete M30 with tremix treatment for 200 mm thickness for flooring with groove cutting of 4mm wide and 20mm deep with necessary refilling with bitumen etc. complete.

**SSR OF 2021-22 ITEM NO. 33.31 & PAGE NO.277**

FOR FLOORING

1 X 1 X 12.00 X 9.00	= 108.000
<b>TOTAL QUANTITY</b>	<b>108.000</b>

Sq.M.

- 14 **ROYALTY CHARGES** :- Supply of Rubble, Murum, Soil, 60mm./40mm. metal (Hand broken), royalty charges are not included in the rates.[As per Govt. of Maharashtra, Revenue and Forest Departments Gazette No.67 Dt.15 May,2015. States that the royalty charges of Rs.141.34/Cu.M. ) are considered. The surcharge levied on Royalty shall also be payable to the contractor

**E DSR ITEM NO. ... & PAGE NO....**

SAND	= 19.100
MURUM-HARD	= 32.400
SOLING	= 21.600

**TOTAL QUANTITY 73.100**

- 15 **Laboratory testing charges** are not considered in the Rate Abstracts. Where ever required separate Item shall be taken in the estimate for material testing charges, on the basis of testing frequency and charges fixed by Vigilance & Quality Control Circle, for the current year and shall form part of tender. testing of material by Quality control and **certified**

**BASIC TEST OF AGGREGATE**



*(Handwritten Signature)*

**Er. Anant V. Gade**

D.C.E., B.E. Civil, B.A., B.G.L., LL.B.,  
PG.D.H.R.D., PG.D. Envir.Sci., PG.D.Val.,  
PG. D.I.S.&S.M., PG.G.D.C.&A., M.A. Socio.  
LL.M., PG.D.Guid.& Conus., (M.B.A.)  
Architectural Consultant and  
Govt.Regd. Valuer

# MEASUREMENT SHEET.

SR. NO.	DESCRIPTION OF ITEM	NO.	L	B	D	QUANTITY
	Water Absorption, Specific Gravity, Impact Value, Crushing Value	1				Nos. = 1.000
	<b>BASIC TEST OF CEMENT</b> Standard Consistency Fineness, Specific Gravity, Setting Time (Initial & Final), Compressive Strength, Soundness	1				Nos. = 1.000
	<b>BRICKS</b> Water Absorption, Compressive Strength, Efflorescence (Set of 5 bricks)	1				Nos. = 1.000
	<b>CONCRETE</b> Compressive strength of C.C.Cube (Set of 3 cubes)	9				Nos. = 9.000
	<b>MURUM-HARD</b> Sieve Analysis	1				Nos. = 1.000
	<b>STEEL BAR TESTING</b> Upto 16 mm (Set of 3 Bars)	0				Nos. = 0.000
<b>TOTAL QUANTITY</b>						<b>13.000</b>



*(Handwritten Signature)*

Engineer/ Architect

**Er. Anant V. Gade**

D.C.E., B.E. Civil, B.A., B.G.L., LL.B.,  
PG.D.H.R.D., PG.D. Envir.Sci., PG.D. Val.,  
PG. D.I.S.&S.M., PG.G.D.C.&A., M.A. Socio.  
LL.M., PG.D. Guid. & Conus., (M.B.A.)  
Architectural Consultant and  
Govt. Regd. Valuer

## RATE ANALYSIS. (BASIC RATES AS PER SSR 2021-22)

DESCRIPTION OF ITEM	QTY.	NET LEAD CHARGES	RATE
Providing and laying <b>Cast in situ/Ready Mix cement concrete M-20</b> of trap / granite /quartzite/ gneiss metal for <b>R.C.C. beams and lintels</b> as per detailed designs and drawings or as directed including steel centering, formwork, cover blocks, laying/pumping, compaction and roughening the surface if special finish is to be provided and curing etc. complete. (Excluding reinforcement and structural steel). with fully automatic micro processor based PLC with SCADA enabled reversible Drum Type mixer/ concrete Batch mix plant (Pan mixer) etc. complete. <b>With fine aggregate</b> <b>BASIC RATE AS PER SSR OF 2021-22 ITEM NO. 25.5 &amp; PAGE NO.234</b>			<b>11483.00</b>
<b>DEDUCT ROYALTY CHARGES FOR SAND</b>	0.42500	141.34	-60.07
			<b>11422.93</b>
<b>ADD LEAD CHARGES FOR CEMENT</b>	0.35000	165.55	57.94
<b>ADD LEAD CHARGES FOR SAND</b>	0.42500	947.37	402.63
<b>ADD LEAD CHARGES FOR CR METAL</b>	0.85000	300.37	255.31
<b>@ADD DIFF.COST FOR SAND</b>	0.42500	625.00	265.63
<b>@ADD DIFF.COST FOR 20MM METAL</b>	0.57000	-96.00	-54.72
<b>@DEDUCT DIFF.COST FOR 12MM METAL</b>	0.28000	96.00	-26.88
<b>TOTAL</b>			12322.84
<b>DEDUCT 10% FOR SCADA</b>			-1232.28
			<b>11090.56</b>
		<b>TOTAL RATE Rs.</b>	<b>11090.56</b> PerCu.M.

Providing and laying <b>Cast in situ/Ready Mix cement concrete M-20</b> of trap/ granite/ quartzite/ gneiss metal for <b>R.C.C. chajja</b> as per detailed design and drawings including centering, formwork, cover blocks compacting , curing , finishing and roughening the surface if special finish is to be provided and curing complete. (Excluding reinforcement and structural steel).with fully automatic micro processor based PLC with SCADA enabled reversible Drum Type mixer/ concrete Batch mix plant (Pan mixer) etc. complete. <b>With fine aggregate (Natural Sand / Crushed sand</b> <b>BASIC RATE AS PER SSR OF 2021-22 ITEM NO. 26.05 &amp; PAGE NO.239</b>			<b>13111.00</b>
<b>DEDUCT ROYALTY CHARGES FOR SAND</b>	0.42500	141.34	-60.07
			<b>13050.93</b>
<b>ADD LEAD CHARGES FOR CEMENT</b>	0.35000	165.55	57.94
<b>ADD LEAD CHARGES FOR SAND</b>	0.42500	947.37	402.63
<b>ADD LEAD CHARGES FOR CR METAL</b>	0.85000	300.37	255.31
<b>@ADD DIFF.COST FOR SAND</b>	0.42500	625.00	265.63
<b>@ADD DIFF.COST FOR 20MM METAL</b>	0.57000	-96.00	-54.72
<b>@DEDUCT DIFF.COST FOR 12MM METAL</b>	0.28000	96.00	-26.88
<b>TOTAL</b>			13950.84
<b>DEDUCT 10% FOR SCADA</b>			-1395.08
			<b>12555.76</b>
		<b>TOTAL RATE Rs.</b>	<b>12555.76</b> PerCu.M.

## RATE ANALYSIS. (BASIC RATES AS PER SSR 2021-22)

DESCRIPTION OF ITEM	QTY.	NET LEAD CHARGES	RATE
Providing and laying <b>Cast in situ/Ready Mix cement concrete M-25</b> of trap / granite / quartzite / gneiss metal for <b>R.C.C. canopy</b> as per detailed designs and drawings including centering, formwork, laying/pumping, compacting and roughening the surface if special finish is to be provided and curing etc. complete (excluding reinforcement). <b>with fully automatic micro processor based PLC with SCADA</b> enabled reversible Drum Type mixer/ concrete Batch mix plant (Pan mixer) etc. complete. <b>With fine aggregate (Natural Sand / Crushed sand VSI Grade)</b> <b>BASIC RATE AS PER SSR OF 2021-22 ITEM NO. 26.11 &amp; PAGE NO.240</b>			<b>13283.00</b>
<b>DEDUCT ROYALTY CHARGES FOR SAND</b>	0.42500	141.34	-60.07
			<b>13222.93</b>
<b>ADD LEAD CHARGES FOR CEMENT</b>	0.37500	165.55	62.08
<b>ADD LEAD CHARGES FOR SAND</b>	0.42500	947.37	402.63
<b>ADD LEAD CHARGES FOR CR METAL</b>	0.85000	300.37	255.31
<b>@ADD DIFF.COST FOR SAND</b>	0.42500	625.00	265.63
<b>@ADD DIFF.COST FOR 20MM METAL</b>	0.57000	-96.00	-54.72
<b>@DEDUCT DIFF.COST FOR 12MM METAL</b>	0.28000	96.00	-26.88
<b>TOTAL</b>			14126.98
<b>DEDUCT 10% FOR SCADA</b>			-1412.70
			<b>12714.28</b>
			PerCu.M.
			<b>TOTAL RATE Rs.</b>

Providing and laying <b>Cast in situ/Ready Mix cement concrete in M-20</b> of trap / quartzite / granite / gneiss metal for <b>R.C.C. Waist slab, and steps of staircases</b> as per detailed design and drawings or as directed including steel centering, plywood/ steel formwork, steel props, laying/pumping, compaction, finishing uneven and honeycombed surface with C.M. 1:3 of sufficient minimum thickness to give a smooth and even surface or roughening the surface if special finish is to be provided and curing etc. complete. (Excluding einforcement, including cover block).(Newly laid concrete shall be covered by gunny bag, plastic, tarpaulin etc.) <b>with fully automatic micro processor based PLC with SCADA</b> enabled reversible Drum Type mixer/ concrete Batch mix plant (Pan mixer) etc. <b>BASIC RATE AS PER SSR OF 2021-22 ITEM NO. 26.25 &amp; PAGE NO.241</b>			<b>13137.00</b>
<b>DEDUCT ROYALTY CHARGES FOR SAND</b>	0.42500	141.34	-60.07
			<b>13076.93</b>
<b>ADD LEAD CHARGES FOR CEMENT</b>	0.35000	165.55	57.94
<b>ADD LEAD CHARGES FOR SAND</b>	0.42500	947.37	402.63
<b>ADD LEAD CHARGES FOR CR METAL</b>	0.85000	300.37	255.31
<b>@ADD DIFF.COST FOR SAND</b>	0.42500	625.00	265.63
<b>@ADD DIFF.COST FOR 20MM METAL</b>	0.57000	-96.00	-54.72
<b>@DEDUCT DIFF.COST FOR 12MM METAL</b>	0.28000	96.00	-26.88
<b>TOTAL</b>			13976.84
<b>DEDUCT 10% FOR SCADA</b>			-1397.68
			<b>12579.16</b>
			PerCu.M.
			<b>TOTAL RATE Rs.</b>

# RATE ANALYSIS. (BASIC RATES AS PER SSR 2021-22)

SR. NO.	DESCRIPTION OF ITEM	QTY.	NET LEAD CHARGES	RATE
11	Providing and fixing in position TMT - FE - 500 bar reinforcement of various diameters for R.C.C. pile caps, footings, foundations, slabs, beams columns, canopies, staircase, newels, chajjas, lintels pardis, copings, fins, arches etc. as per detailed designs, drawings and schedules. including cutting, bending, hooking the bars, binding with wires or tack welding and supporting			
	<b>BASIC RATE AS PER SSR OF 2021-22 ITEM NO. 26.33 &amp; PAGE NO.245</b>			<b>71778.00</b>
	<b>ADD LEAD CHARGES FOR STEEL</b>	1.00000	165.55	165.55
	<b>TOTAL RATE Rs.</b>			<b>71943.55</b> PerM.T.
12	Providing second class Burnt Brick masonry with conventional/ I.S. type bricks in cement mortar 1:6 in foundations and plinth of inner walls/ in plinth external walls including bailing out water manually , striking joints on unexposed faces, raking out joints on			
	<b>BASIC RATE AS PER SSR OF 2021-22 ITEM NO. 27.01 &amp; PAGE NO.254</b>			<b>7343.00</b>
	<b>DEDUCT ROYALTY CHARGES FOR SAND</b>	0.32000	141.34	-45.23
	<b>ADD LEAD CHARGES FOR CEMENT</b>	0.07900	165.55	13.08
	<b>ADD LEAD CHARGES FOR SAND</b>	0.32000	947.37	303.16
	<b>ADD LEAD CHARGES FOR BRICKS</b>	0.47500	533.16	253.25
	<b>@ADD DIFF.COST FOR SAND</b>	0.32000	625.00	200.00
	<b>TOTAL RATE Rs.</b>			<b>8067.26</b> PerCu.M.
13	Filling in plinth and floors with approved excavated material in 15cm. to 20cm. layers including watering and compacting etc. complete.			
	<b>BASIC RATE AS PER SSR OF 2021-22 ITEM NO. 21.36 &amp; PAGE NO.201</b>			<b>113.00</b>
	<b>TOTAL RATE Rs.</b>			<b>113.00</b> PerCu.M.
14	Filling in plinth and floors with contractors material/brought from outside and approved by Engineer incharge in layers of 15cm. to 20cm. including watering and compaction etc. complete.			
	<b>BASIC RATE AS PER SSR OF 2021-22 ITEM NO. 21.37 &amp; PAGE NO.201</b>			<b>550.00</b>
	<b>ADD LEAD CHARGES FOR MURUM-HARD</b>	1.00000	186.55	186.55
	<b>@ADD DIFF.COST FOR MURUM-HARD</b>	1.00000	-8.00	-8.00
	<b>TOTAL RATE Rs.</b>			<b>728.55</b> PerCu.M.
15	Providing soling using 80 mm size trap metal in 15 cm. layer including filling voids with Crushed sand/grit, ramming, watering etc. complete			
	<b>BASIC RATE AS PER SSR OF 2021-22 ITEM NO. 21.4 &amp; PAGE NO.201</b>			<b>1322.00</b>
	<b>ADD LEAD CHARGES FOR SOLING</b>	1.00000	367.47	367.47
	<b>ADD LEAD CHARGES FOR GRIT</b>	0.15000	287.86	43.18
	<b>@ADD DIFF.COST FOR GRIT</b>	0.15000	20.00	3.00
	<b>TOTAL RATE Rs.</b>			<b>1735.65</b> PerCu.M.
16	Providing second class Burnt Brick masonry with conventional/ I.S. type bricks in cement mortar 1:6 in superstructure including striking joints, raking out joints, watering and scaffolding etc. Complete			

# RATE ANALYSIS. (BASIC RATES AS PER SSR 2021-22)

SR. NO.	DESCRIPTION OF ITEM	QTY.	NET LEAD CHARGES	RATE	
17	<b>BASIC RATE AS PER SSR OF 2021-22 ITEM NO. 27.05 &amp; PAGE NO.254</b>			<b>7570.00</b>	
	DEDUCT ROYALTY CHARGES FOR SAND	0.32000	141.34	-45.23	
	ADD LEAD CHARGES FOR CEMENT	0.07900	165.55	<u>7524.77</u>	
	ADD LEAD CHARGES FOR SAND	0.32000	947.37	13.08	
	ADD LEAD CHARGES FOR BRICKS	0.47500	533.16	303.16	
	@ADD DIFF.COST FOR SAND	0.32000	625.00	253.25	
				200.00	
	<b>TOTAL RATE Rs.</b>			<b>8294.26</b>	
				PerCu.M.	
	8	<b>BASIC RATE AS PER SSR OF 2021-22 ITEM NO. 32.06 &amp; PAGE NO.268</b>			<b>359.00</b>
DEDUCT ROYALTY CHARGES FOR SAND		0.02500	141.34	-3.53	
ADD LEAD CHARGES FOR CEMENT		0.00700	165.55	<u>355.47</u>	
ADD LEAD CHARGES FOR SAND		0.02500	947.37	1.16	
@ADD DIFF.COST FOR SAND		0.02500	625.00	23.68	
				15.63	
<b>TOTAL RATE Rs.</b>				<b>395.94</b>	
				PerSq.M.	
8		<b>BASIC RATE AS PER SSR OF 2021-22 ITEM NO. 32.11 &amp; PAGE NO.269</b>			<b>599.00</b>
		DEDUCT ROYALTY CHARGES FOR SAND	0.03300	141.34	-4.66
	ADD LEAD CHARGES FOR CEMENT	0.01250	165.55	<u>594.34</u>	
	ADD LEAD CHARGES FOR SAND	0.03300	947.37	2.07	
	@ADD DIFF.COST FOR SAND	0.03300	625.00	31.26	
				20.63	
	<b>TOTAL RATE Rs.</b>			<b>648.30</b>	
				PerSq.M.	
		<b>BASIC RATE AS PER SSR OF 2021-22 ITEM NO. 23.01 &amp; PAGE NO.223</b>			<b>89181.00</b>
		<b>TOTAL RATE Rs.</b>			<b>89181.00</b>
				PerM.T.	

# RATE ANALYSIS. (BASIC RATES AS PER SSR 2021-22)

DESCRIPTION OF ITEM	QTY.	NET LEAD CHARGES	RATE
20 Providing and fixing in position <b>factory made box type steel window</b> with glazed fanlight including steel windows of cold rolled section of 105mm x 60mm x 1.25mm thick frame section filled with cement concrete (1:2:4) and metal pressed steel shutters of 20 gauge (1mm) as per detailed drawing and design or as directed including providing horizontal mild steel 12mm square bars at 10cm center to center, required F-7B section, section 7-6, section 20mm x 5mm mild steel flat for shutter and F4B section for frame, 3mm thick glass of approved quality for fanlight necessary fixtures and fastening etc. complete finishing with one coat <b>BASIC RATE AS PER SSR OF 2021-22 ITEM NO. 39.22 &amp; PAGE NO.317</b>			<b>5150.00</b>
<b>TOTAL RATE Rs.</b>			<b>5150.00</b> PerSq.M.
21 Providing and fixing <b>rolling shutter fabricated from steel laths of minimum thickness 0.9 mm</b> with lock plate of 3.15 mm thickness reinforced with 35 x 35 x 5 mm angle section fitted with sliding bolts and handles for both sides, deep M.S. channel section of depth and thickness not less than 65 mm and 3.15 mm respectively with hold fast arrangements, M.S. Bracket plate 300 x 300 x 3.15 mm minimum size and shape with square bar, suspension shaft of minimum 32 mm diameter, hood cover of M.S. sheet not less than 0.9 mm thickness and of any size at top and safety devices including mechanical gear operation arrangement consisting of worm gear wheels and worms of high grade cast iron or mild steel and one coat of red lead <b>BASIC RATE AS PER SSR OF 2021-22 ITEM NO. 39.24 &amp; PAGE NO.318</b>			<b>4310.00</b>
<b>TOTAL RATE Rs.</b>			<b>4310.00</b> PerSq.M.
22 Providing and <b>applying white-wash in two coats</b> on old / new plastered or masonry surfaces and asbestos cement sheets including scaffolding and preparing the surface by brushing & brooming down etc. complete <b>BASIC RATE AS PER SSR OF 2021-22 ITEM NO. 36.03 &amp; PAGE NO.290</b>			<b>11.00</b>
<b>TOTAL RATE Rs.</b>			<b>11.00</b> PerSq.M.
23 Providing and <b>applying washable oil-bound distemper</b> of approved colour and shade to old & new surfaces in <b>two coats</b> including scaffolding, preparing the surfaces. (excluding the primer coat) etc. complete <b>BASIC RATE AS PER SSR OF 2021-22 ITEM NO. 36.11 &amp; PAGE NO.291</b>			<b>43.00</b>
<b>TOTAL RATE Rs.</b>			<b>43.00</b> PerSq.M.
24 Providing and <b>applying three coats of water proof cement paint</b> of approved manufacture and of approved colour to <b>new plastered surfaces</b> including scaffolding if necessary, cleaning and preparing the surface, watering for <b>BASIC RATE AS PER SSR OF 2021-22 ITEM NO. 35.15 &amp; PAGE NO.287</b>			<b>97.00</b>
<b>TOTAL RATE Rs.</b>			<b>97.00</b> PerSq.M.



[Signature]

**Er. Anant V. Gade**

D.C.E., B.E. Civil, B.A., B.G.L., LL.B.,  
 PG.D.H.R.D., PG.D. Envir. Sci., PG.D. Val.,  
 PG. D.I.S. & S.M., PG.G.D.C. & A., M.A. Socio.  
 LL.M., PG.D. Guid. & Conus., (M.B.A.)  
 Architectural Consultant and  
 Govt. Regd. Valuer

# RATE ANALYSIS. (BASIC RATES AS PER SSR 2021-22)

DESCRIPTION OF ITEM	QTY.	NET LEAD CHARGES	RATE
Providing and fixing colour coated Zinalume ( R ) AZ150 ( min. 150 gms/sq.mt. total on each side ) profiled sheets for roofing. The feed material is manufactured out of nominal 0.45 mm Base Metal Thickness ( BMT ) (0.5 mm TCT ), High strength steel with min.550 MPa yield strength, metallic hot dip coated with Aluminium-Zinc alloy (55% aluminium and 43.4% zinc 1.6% silicon) with COLORBOND ( R ) steel quality super durable polyester paint coat ( with inorganic pigment). The paint shall have a total coating thickness of nominal 35 um, comprising of nominal 25 um exterior coat on top surface and nominal 10 um reverse coat on back surface. Profile sheet shall have nom. 950-1050 mm effective cover width and nominal 25-30 mm deep ribs with subtle square fluting in the five pan at nominal 180-250 mm center-to-center. The end rib shall be designed for anti-capillary groove. and return leg. The feed material should have coil manufacturers product details marked a regular interval. Including fasteners with min. fastened with min. 25 mm Zinc-Tin alloy coated Hex head self-drilling screw etc.			<b>1095.00</b>
<b>TOTAL RATE Rs.</b>			<b>1095.00</b> PerSq.M.

Providing and laying in situ cement concrete M30 with tremix treatment for 200 mm thickness for flooring with groove cutting of 4mm wide and 20mm deep with necessary refilling with bitumen etc. complete.

**BASIC RATE AS PER SSR OF 2021-22 ITEM NO. 33.31 & PAGE NO.277**  
**DEDUCT ROYALTY CHARGES FOR SAND**

	0.08500	141.34	<u>-12.01</u>
			<b>1366.99</b>
<b>ADD LEAD CHARGES FOR CEMENT</b>	0.08000	165.55	13.24
<b>ADD LEAD CHARGES FOR SAND</b>	0.08500	947.37	80.53
<b>ADD DIFF.COST FOR SAND</b>	0.08500	625.00	53.13
<b>ADD LEAD CHARGES FOR CR METAL</b>	0.17000	300.37	51.06
<b>ADD DIFF.COST FOR CR METAL</b>	0.17000	-96.00	-16.32
<b>TOTAL RATE Rs.</b>			<b>1548.63</b> PerSq.M.

Engineer/ Architect

NAME OF WORK:- PROPOSED CONSTRUCTION OF PARKING SHED ( For Agri. Vehicles and equipments) AT GAT NO. 354/ Part OF VILL. KARADKHEL , TQ. UDGIR, DIST. LATUR. FOR : FARM RICH PRODUCER COMPANY LTD., LATUR.

### DIFF.COST OF MATERIAL

SR. NO.	MATERIAL	RATE AS PER SSR OF 2021-22	MARKET RATE	EXCESS	LESS	REMARKS/ EFFECTIVE DATE
1	SAND	1575.00	2200.00	625.00	0.00	Rate As On
2	20MM METAL	996.00	900.00	-96.00	0.00	Rate As On
3	12MM METAL	996.00	900.00	96.00	0	Rate As On
4	MURUM-HARD	288.00	280.00	-8.00	0.00	Rate As On
5	GRIT	800.00	820.00	20.00	0.00	Rate As On



Engineer/ Architect



**Er. Anant V. Gade**

D.C.E., B.E. Civil, B.A., B.G.L., LL.B.,  
PG.D.H.R.D., PG.D. Envir.Sci., PG.D.Val.,  
PG. D.I.S.&S.M., PG.G.D.C.&A., M.A. Socio.  
LL.M., PG.D.Guid.& Conus., (M.B.A.)  
Architectural Consultant and  
Govt.Regd.Valuer

**NAME OF WORK:- PROPOSED CONSTRUCTION OF PARKING SHED ( For Agri. Vehicles and equipments) AT GAT NO. 354/ Part OF VILL. KARADKHEL , TQ. UDGIR, DIST. LATUR. FOR : FARM RICH PRODUCER COMPANY LTD., LATUR.**

**RATE ANALYSIS. (BASIC RATES AS PER SSR 2021-22)**

SR. NO.	DESCRIPTION OF ITEM	QTY.	NET LEAD CHARGES	RATE
1	Excavation for <b>foundation in earth, soil of all types, sand, gravel and soft murum</b> , including removing the excavated material up to a distance of 50 m. beyond the building area & stacking and spreading as directed, dewatering, preparing the bed for the foundation and necessary back filling, ramming, watering including shoring and strutting etc. complete. <b>(Lift upto 1.5 m.) By BASIC RATE AS PER SSR OF 2021-22 ITEM NO. 21.02 &amp; PAGE NO.197</b>			<b>193.00</b>
	<b>TOTAL RATE Rs.</b>			<b>193.00</b> PerCu.M.
2	Excavation for <b>foundation in hard murum</b> including removing the excavated material upto distance of 50 metres beyond the building area and stacking and spreading as directed, dewatering, preparing the bed for the foundation and necessary back filling, ramming, watering including shoring and strutting etc. complete. <b>(Lift upto 1.50 m) By BASIC RATE AS PER SSR OF 2021-22 ITEM NO. 21.06 &amp; PAGE NO.197</b>			<b>212.00</b>
	<b>TOTAL RATE Rs.</b>			<b>212.00</b> PerCu.M.
3	Excavation for <b>foundation in Hard murum and boulders</b> including removing the excavated material upto a distance of 50 metres, beyond the building area and stacking and spreading as directed, dewatering, preparing the bed for the foundation and necessary back filling, ramming, watering including shoring and strutting etc. complete. <b>(Lift from 1.5 m to 3.0 m ) By Mechanical Means BASIC RATE AS PER SSR OF 2021-22 ITEM NO. 21.12 &amp; PAGE NO.198</b>			<b>291.00</b>
	<b>TOTAL RATE Rs.</b>			<b>291.00</b> PerCu.M.
4	Providing and laying <b>Cast in situ/Ready Mix cement concrete in M-10</b> of trap/ granite/ quartzite/ gneiss metal <b>for foundation and bedding</b> including bailing out water, formwork, laying/pumping, compacting, roughening them if special finish is to be provided, finishing if required and curing complete, <b>with fully automatic micro processor based PLC with SCADA</b> enabled reversible Drum Type mixer/concrete Batch mix plant (Pan mixer) etc. complete. <b>With fine aggregate (Natural Sand / Crushed sand BASIC RATE AS PER SSR OF 2021-22 ITEM NO. 24.01 &amp; PAGE NO.226</b>			<b>5538.00</b>
	<b>DEDUCT ROYALTY CHARGES FOR SAND</b>	0.47000	141.34	<b>-66.43</b>
				<b>5471.57</b>
	<b>ADD LEAD CHARGES FOR CEMENT</b>	0.22000	165.55	36.42
	<b>ADD LEAD CHARGES FOR SAND</b>	0.47000	947.37	445.26
	<b>ADD LEAD CHARGES FOR CR METAL</b>	0.24000	300.37	72.09
	<b>ADD LEAD CHARGES FOR 40MM METAL CB</b>	0.70000	278.70	195.09
	<b>@ADD DIFF.COST FOR SAND</b>	0.47000	625.00	293.75
	<b>@ADD DIFF.COST FOR 20MM METAL</b>	0.24000	-96.00	-23.04
	<b>TOTAL</b>			6491.14
	<b>DEDUCT 10% FOR SCADA</b>			-649.11
	<b>TOTAL RATE Rs.</b>			<b>5842.03</b> PerCu.M.

# RATE ANALYSIS. (BASIC RATES AS PER SSR 2021-22)

SR. NO.	DESCRIPTION OF ITEM	QTY.	NET LEAD CHARGES	RATE
5	Providing and laying in situ/Ready Mix cement concrete M-20 of trap / granite /quartzite/ gneiss metal for R.C.C. grillage and footings of R.C.C. columns and steel stanchions etc. including bailing out water, formwork, laying/pumping cover blocks, compaction and curing roughening the surface if special finish is to be provided (Excluding reinforcement and structural steel) etc. complete, with fully automatic micro processor based PLC with SCADA enabled reversible Drum Type mixer/ concrete Batch mix plant (Pan mixer) etc. complete. With fine aggregate (Natural Sand) etc. complete. With <b>BASIC RATE AS PER SSR OF 2021-22 ITEM NO. 25.11 &amp; PAGE NO.230</b>			<b>6666.00</b>
	DEDUCT ROYALTY CHARGES FOR SAND			6666.00
	ADD LEAD CHARGES FOR CEMENT	0.42500	141.34	-60.07
	ADD LEAD CHARGES FOR SAND			<u>6605.93</u>
	ADD LEAD CHARGES FOR CR METAL	0.35000	165.55	57.94
	@ADD DIFF.COST FOR SAND	0.42500	947.37	402.63
	@ADD DIFF.COST FOR 20MM METAL	0.85000	300.37	255.31
	@DEDUCT DIFF.COST FOR 12MM METAL	0.42500	625.00	265.63
	TOTAL	0.57000	-96.00	-54.72
	DEDUCT 10% FOR SCADA	0.28000	96.00	-26.88
				7505.84
				<u>-750.58</u>
	<b>TOTAL RATE Rs.</b>			<b>6755.26</b> PerCu.M.

6	Providing and laying Cast in situ/Ready Mix cement concrete M-20 of trap / granite /quartzite/ gneiss metal for R.C.C. columns as per detailed designs and drawing or as directed including centering, formwork, cover blocks, laying/pumping, compaction finishing the formed surfaces with cement mortar 1:3 of sufficient minimum thickness to give a smooth and even surface or roughening if special finish is to be provided and curing etc. complete,(Excluding reinforcement and structural steel).with fully automatic micro processor based PLC with SCADA enabled reversible Drum Type mixer/ concrete Batch mix plant (Pan mixer) etc. complete. With fine aggregate (Natural Sand) etc. complete. With <b>BASIC RATE AS PER SSR OF 2021-22 ITEM NO. 25.31 &amp; PAGE NO.232</b>			<b>12987.00</b>
	DEDUCT ROYALTY CHARGES FOR SAND			12987.00
	ADD LEAD CHARGES FOR CEMENT	0.42500	141.34	-60.07
	ADD LEAD CHARGES FOR SAND			<u>12926.93</u>
	ADD LEAD CHARGES FOR CR METAL	0.35000	165.55	57.94
	@ADD DIFF.COST FOR SAND	0.42500	947.37	402.63
	@ADD DIFF.COST FOR 20MM METAL	0.85000	300.37	255.31
	@DEDUCT DIFF.COST FOR 12MM METAL	0.42500	625.00	265.63
	TOTAL	0.57000	-96.00	-54.72
	DEDUCT 10% FOR SCADA	0.28000	96.00	-26.88
				13826.84
				<u>-1382.68</u>
	<b>TOTAL RATE Rs.</b>			<b>12444.16</b> PerCu.M.



**Er. Anant V. Gade**  
 D.C.E., B.E. Civil, B.A., B.G.L., LL.B.,  
 PG.D.H.R.D., PG.D. Envir.Sci., PG.D.Val.,  
 PG. D.I.S.&S.M., PG.G.D.C.&A., M.A.Socio,  
 LL.M., PG.D.Guid.&Conus., (M.B.A.)  
 Architectural Consultant and  
 Govt.Regd.Valuer

**NAME OF WORK:- PROPOSED CONSTRUCTION OF PARKING SHED ( For Agri. Vehicles and equipments) AT GAT NO. 354/ Part OF VILL. KARADKHEL , TQ. UDGIR, DIST. LATUR. FOR : FARM RICH PRODUCER COMPANY LTD., LATUR.**

### MATERIAL SUMMARY

SR.NO.	MATERIAL	TOTAL QUANTITY	QUANTITY OF ROYALTY	REMARKS
1	CEMENT	#REF!	-	
2	SAND	19.100	19.100	
3	CR METAL	26.952	-	
4	40MM METAL CB	7.724	-	
5	STEEL	-	-	
6	BRICKS	2.294	-	
7	MURUM-HARD	32.400	32.400	
8	SOLING	21.600	21.600	
9	GRIT	3.240	-	



*[Handwritten Signature]*

Engineer/ Architect

**Er. Anant V. Gade**

D.C.E., B.E. Civil, B.A., B.G.L., LL.B.,  
 PG.D.H.R.D., PG.D. Envir.Sci., PG.D.Val.,  
 PG. D.I.S.&S.M., PG.G.D.C.&A., M.A. Socio.  
 LL.M., PG.D.Guid.& Conus., (M.B.A.)  
 Architectural Consultant and  
 Govt.Regd.Valuer

**NAME OF WORK:- PROPOSED CONSTRUCTION OF WARE HOUSE UNIT UNDER SMART PROJECT SCHEME AT GAT NO. 354/ Part OF VILL- KARADKHEL, TQ. UDGIR, DIST. LATUR. FOR: FARM RICH PRODUCER COMPANY LTD., LATUR.**

**OTHER MATERIAL COMPONENTS**

Sr No.	Item Of Work	Quantity	CEMENT		SAND		CR METAL		40MM METAL CB		STEEL		BRICKS		MURUM-HARD		SOLING		GRIT		
			Cons.	Qty.	Cons.	Qty.	Cons.	Qty.	Cons.	Qty.	Cons.	Qty.	Cons.	Qty.	Cons.	Qty.	Cons.	Qty.	Cons.	Qty.	
1	2	3	4	5	6	7	8	9	10	11	12	13	14	15	16	17	18	19	20	21	
1	Providing and laying Cast in situ/Ready Mix cement concrete in M-10 of trap/ granite/ quartzite/ gneiss metal for foundation and bedding including bailing out water, formwork, laying/pumping, compacting, roughening them if special finish is to be provided, finishing if required and curing.	11.034	0.22000	2.427	0.47000	5.186	0.24000	2.648	0.70000	7.724											
2	Providing and laying in situ/Ready Mix cement concrete M-20 of trap / granite /quartzite/ gneiss metal for R.C.C. work in foundations like raft, strip foundations, grillage and footings of R.C.C. columns and steel stanchions etc. including bailing out water, formwork, laying/pumping cover blocks, compaction and curing	2.520	0.35000	0.882	0.42500	1.071	0.85000	2.142													
3	Providing and laying Cast in situ/Ready Mix cement concrete M-20 of trap / granite /quartzite/ gneiss metal for R.C.C. columns as per detailed designs and drawing or as directed including centering.	0.000	0.35000	0.000	0.42500	0.000	0.85000	0.000													
4	Providing and laying Cast in situ/Ready Mix cement concrete M-20 of trap / granite /quartzite/ gneiss metal for R.C.C. beams and lintels as per detailed designs and drawings or as directed including steel	1.932	0.35000	0.676	0.42500	0.821	0.85000	1.642													
5	Providing and laying Cast in situ/Ready Mix cement concrete M-20 of trap/ granite/ quartzite/ gneiss metal for R.C.C. chajja as per detailed design and drawings including centering, formwork, cover blocks	0.000	0.35000	0.000	0.42500	0.000	0.85000	0.000													

Sl No.	Item Of Work	Quantity	CEMENT		SAND		CR METAL		40MM METAL CB		STEEL		BRICKS		MURUM-HARD		SOLING		GRIT	
			Cons.	Qty.	Cons.	Qty.	Cons.	Qty.	Cons.	Qty.	Cons.	Qty.	Cons.	Qty.	Cons.	Qty.	Cons.	Qty.	Cons.	Qty.
1	2	3	4	5	6	7	8	9	10	11	12	13	14	15	16	17	18	19	20	21
6	Providing and laying Cast In situ/Ready Mix cement concrete M-25 of trap / granite / quartzite / gneiss metal for R.C.C. canopy as per detailed designs and drawings including centering, formwork, SSR OF 2019-20 ITEM NO. 26-11 & PAGE NO.260	#REF!	0.37500	0.000	0.42500	0.000	0.85000	0.000												
7	Providing and laying Cast In situ/Ready Mix cement concrete in M-20 of trap / quartzite / granite /gneiss metal for R.C.C. Waist slab, and steps of staircases as per detailed design and drawings or as SSR OF 2019-20 ITEM NO. 26-25 & PAGE NO.261	0.000	0.35000	0.000	0.42500	0.000	0.85000	0.000												
8	Providing and fixing in position TMT - FE - 500 bar reinforcement of various diameters for R.C.C. pile caps, footings, foundations, slabs, beams columns, canopies, staircase, newels, chajjas, lintels SSR OF 2019-20 ITEM NO. 26-33 & PAGE NO.265	0.000						1.00000	0.000											
9	Providing second class Burnt Brick masonry with conventional/ I.S. type bricks in cement mortar 1:6 in foundations and plinth of inner walls/ in plinth external walls including balling out water manually , SSR OF 2019-20 ITEM NO. 27-21 & PAGE NO.284	4.830	0.07900	0.382	0.32000	1.546						0.47500	2.294							
10	Filling in plinth and floors with contractors material/brought from outside and approved by Engineer incharge in layers of 15cm. to 20cm. including watering and compaction etc. complete. SSR OF 2019-20 ITEM NO. 21-37 & PAGE NO.201	32.400													1.00000	32.400				
11	Providing soling using 80 mm size trap metal in 15 cm. layer including filling voids with Crushed sand/grit, ramming, watering etc. complete. SSR OF 2019-20 ITEM NO. 21-4 & PAGE NO.201	21.600															1.00000	21.600	0.15000	3.240
12	Providing second class Burnt Brick masonry with conventional/ I.S. type bricks in cement mortar 1:6 in superstructure including striking and joints, raking out joints, watering and scaffolding etc. Complete SSR OF 2019-20 ITEM NO. 27-02 & PAGE NO.284	0.000	0.07900	0.000	0.32000	0.000							0.47500	0.000						

Sr No.	Item Of Work	Quantity	CEMENT		SAND		CR METAL		40MM METAL CB		STEEL		BRICKS		MURUM-HARD		SOLING		GRIT	
			Cons.	Qty.	Cons.	Qty.	Cons.	Qty.	Cons.	Qty.	Cons.	Qty.	Cons.	Qty.	Cons.	Qty.	Cons.	Qty.	Cons.	Qty.
1	2	3	4	5	6	7	8	9	10	11	12	13	14	15	16	17	18	19	20	21
13	Providing internal cement plaster 20mm thick in two coats in cement mortar 1:5 without neeru finish, to concrete, brick surface, in all positions including scaffolding and curing etc. complete	0.000	0.00700	0.000	0.02500	0.000														
14	Providing sand faced plaster externally in cement mortar using approved screened sand, in all positions including base coat of 15 mm thick in cement mortar 1:4 using waterproofing compound at 1 kg per sqm	#REF!	0.01250	#REF!	0.03300	0.000														
15	Providing and laying in situ cement concrete M30 with tremix treatment for 200 mm thickness for flooring with groove cutting of 4mm wide and 20mm deep with necessary refilling with bitumen etc. complete.	108.000	0.09700	10.476	0.09700	10.476	0.19000	20.520												

#REF!	19.100	26.952	7.724	0.000	2.294	32.400	21.600	3.240
-------	--------	--------	-------	-------	-------	--------	--------	-------

Quantity	CEMENT		SAND		CR METAL		40MM METAL CB		STEEL		BRICKS		MURUM-HARD		SOLING		GRIT	
	Cons.	Qty.	Cons.	Qty.	Cons.	Qty.	Cons.	Qty.	Cons.	Qty.	Cons.	Qty.	Cons.	Qty.	Cons.	Qty.	Cons.	Qty.

*Er. Anant V. Gade*  
 Engineer/ Architect

**Er. Anant V. Gade**  
 D.C.E. B.E. CIVIL, B.A., B.G.L., U.L.B.  
 P.G. D.H.R.D., P.G.D. Envt. Sci., P.G.D. Vel.,  
 P.G. D.I.S. & S.M., P.G. G.D.C. & A., M.A. Socia.  
 LL.M., P.G. D. Grad. & Conus., (M.B.A.)  
 Architectural Consultant and  
 Govt. Regd. Valuer





**NAME OF WORK:- PROPOSED CONSTRUCTION OF PARKING SHED ( For Agri. Vehicles and equipments) AT GAT NO. 354/ Part OF VILL. KARADKHEL , TQ. UDGIR, DIST. LATUR. FOR : FARM RICH PRODUCER COMPANY LTD., LATUR.**

### LEAD CHART

SRL. NO.	MATERIAL	TYPE OF MATERIAL	LOCATION OF QUARRY	LEAD IN KM.	LEAD CHARGES	INITIAL LEAD CHARGES	NET LEAD CHARGES
1	CEMENT	MANUAL	UDGIR	18.00	165.55	0.00	165.55
2	SAND	RIVER	GANGAKHED	80.00	947.37	0.00	947.37
3	CR METAL	MACHINE	UDGIR	18.00	300.37	0.00	300.37
4	40MM METAL CB	MACHINE	UDGIR	18.00	278.70	0.00	278.70
5	STEEL	MANUAL	UDGIR	18.00	165.55	0.00	165.55
6	BRICKS PER 1000 Nos	MANUAL	UDGIR	18.00	533.16	0.00	533.16
7	MURUM-HARD	MACHINE	LOCAL	2.00	186.55	0.00	186.55
8	SOLING	MACHINE	UDGIR	18.00	367.47	0.00	367.47
9	GRIT	MACHINE	UDGIR	18.00	287.86	0.00	287.86



*(Handwritten Signature)*

Engineer/ Architect

**Er. Anant V. Gade**

D.C.E., B.E. Civil, B.A., B.G.L., LL.B.,  
 PG.D.H.R.D., PG.D. Envir. Sci., PG.D. Val.,  
 PG. D.I.S. & S.M., PG.G.D.C. & A., M.A. Socio.  
 LL.M., PG.D. Guid. & Conus., (M.B.A.)  
 Architectural Consultant and  
 Govt. Regd. Valuer

**PROPOSAL :**

PROPOSED CONSTRUCTION OF PARKING SHED AT GAT NO. 354/PART OF KARADKHEL, TQ. UDGIR, DIST. LATUR (MAHARASHTRA).

**PROPOSED BY :**

FARM RICH PRODUCER CO. LTD. BUDHODA, TQ. AUSA, DIST. LATUR.  
THROUGH ITS CHAIRMAN MR. RAMESH SIDRAMAPPA CHILLE.

**SPECIFICATIONS OF SHED:**

M.S. FABRICATED SHED WITH M.S. PIPES FOR VERTICAL COLUMNS AND M.S. SQUARE PIPES FOR GIRDERS AND PURLINS WITH C.G.I. SHEETS (PROFILE) FOR THREE SIDE WALLS AND ROOFING.

C.C. FOUNDATION, MURUM FILLING IN PLINTH, PCC AND TRIMIX FLOORING.

**PROP. B/UP AREA:** 110.11 SQMTR.  
(9.10X12.10M.)

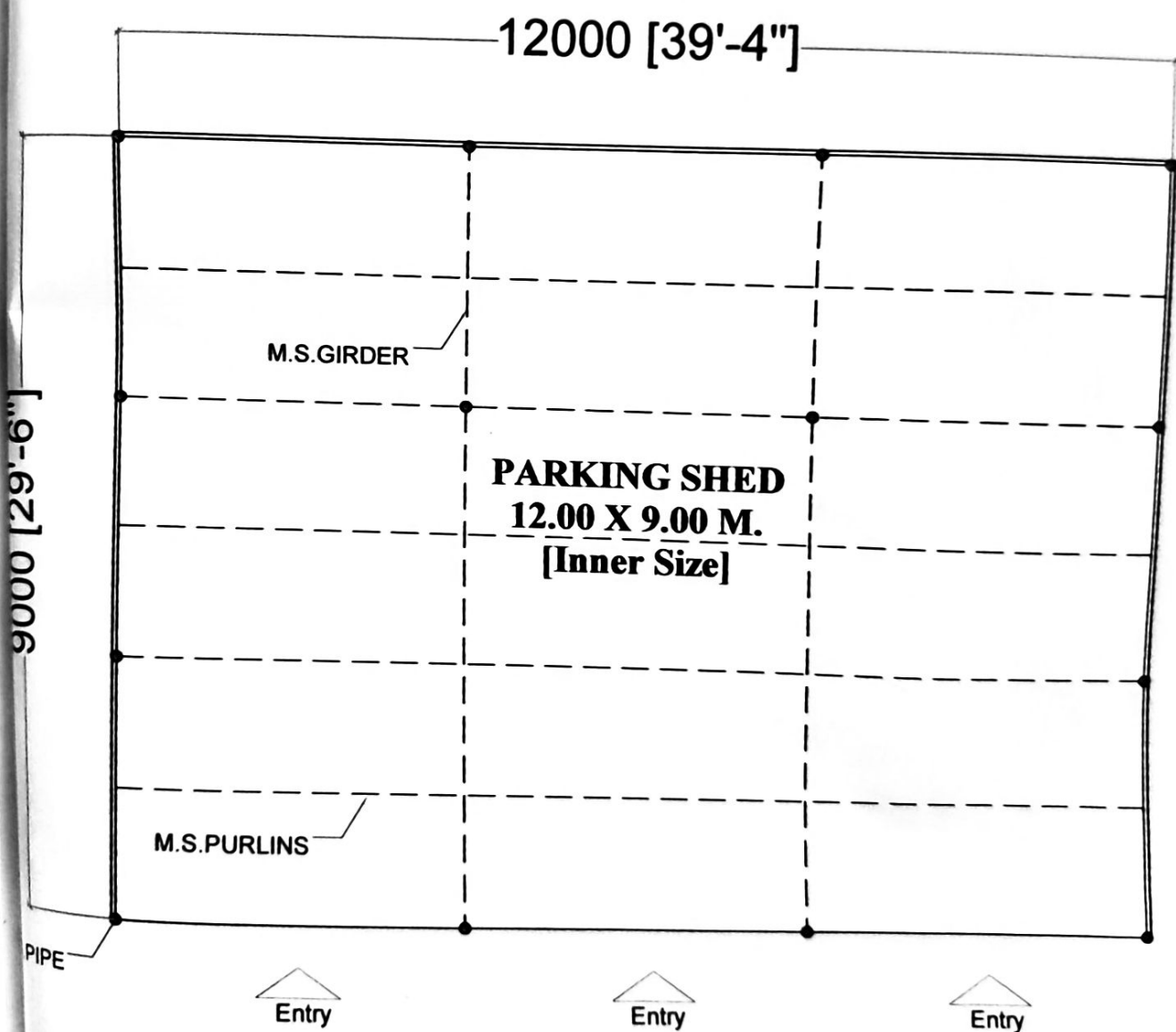

*Handwritten signature of Er. Anant V. Gade*

**PREPARED BY:**

**Er. Anant V. Gade**  
D.C.E., B.E. Civil, B.A., B.G.L., LL.B.,  
PG.D.H.R.D., PG.D. Envir. Sci., PG.D. Val.,  
PG. D.I.S. & S.M., PG.G.D.C. & A., M.A. Socio.  
LL.M., PG.D. Guid. & Conus., (M.B.A.)  
Architectural Consultant and  
Govt. Regd. Valuer